

SUMMER 2019

ROEHAMPTON VOICE



ISSUE 37

Save Our Green !

Maritz Vandenberg

72 Minstead Gardens SW15 4EW

How many Altonians are aware that Redrow's redevelopment proposals for our area, shortly to come before Wandsworth Council as a Planning Application, involve cutting down all the magnificent mature trees on our Library green, and building in their place a 7-storey tower block?

Figure A shows the present green, with the storey heights of surrounding buildings marked.

Figure B shows the expanded green proposed in Wandsworth Council's Alton Area Masterplan. This was published in October 2014 after the

Council's extremely thorough public consultation of February to April 2014. The latter included the hand-delivery of 3,800 questionnaires to every household and business in the area; 55 meetings with local residents; and personal visits to every household affected. The Masterplan was formally adopted in the Council's Supplementary Planning Document of October 2015.

Figure C shows what the Council's chosen developer, Redrow, are now proposing to replace both the Masterplan and SPD - eliminating the Green (now to be built upon, and surrounded by, 7-storey tower blocks) and giving us in return a somewhat larger paved area to replace the current

one on the Co-Op site. Redrow's public consultation comprised in total 2 exhibitions on 6 and 9 June 2018, attended by around 250 people, plus a number of drop-in sessions.

A Planning Application to give effect to Figure C is imminent. May I, as an Altonian of 22 years' standing, call on the local community to resist the building-over of our beloved green, and the cutting down of its magnificent trees, by every orderly and peaceful means at their disposal when the bulldozers and the men with chain-saws start moving in? And for all local community and amenity organisations to support them?

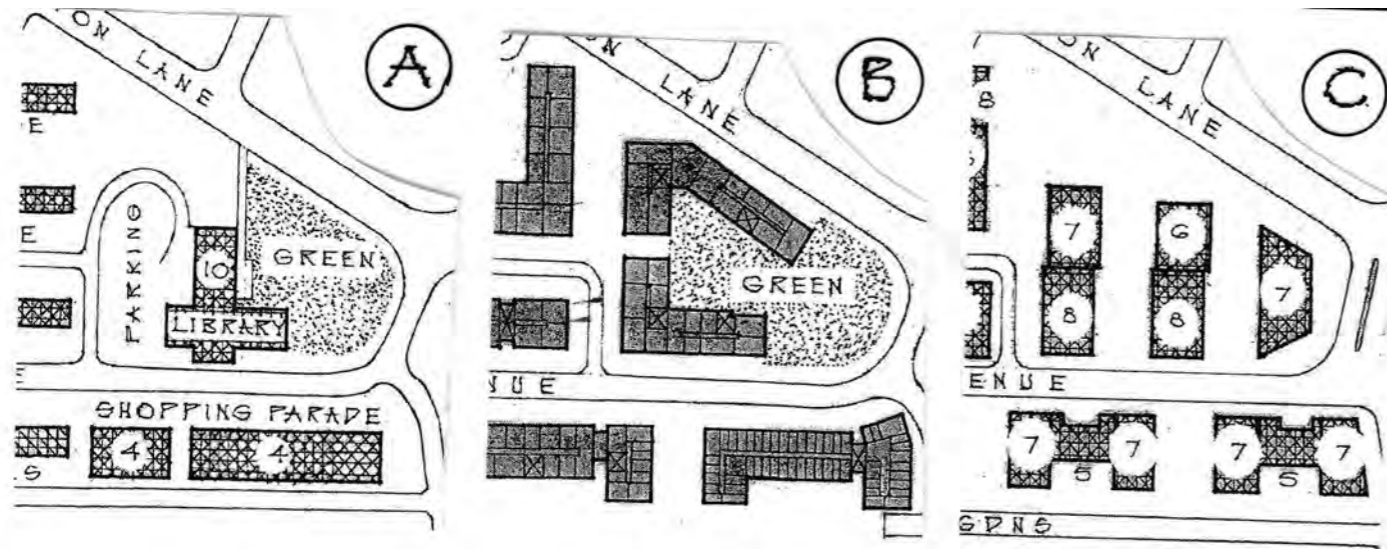

Regeneration - at last, a planning application!

John Horrocks

The long-promised planning application proposing the regeneration of the Alton Estate has now been made. It is being submitted by Redrow, the council's development partner in this redevelopment process.

The submission of the planning application has been delayed for almost a year and a half. It had been promised for February of last year.

As I understand it, the delay has been due to Redrow being unable to get its act together in assembling all the material needed for the application. So, the question might be asked: 'Are we right to think that the council made an unfortunate error in selecting Redrow as its development partner?' And, how confident can we be that Redrow will be

capable of seeing the redevelopment project through? We will have to wait and see.

The application is particularly complex, involving a huge number of documents and plans. It will take a very long time for anyone to study it all.

All the application material is being made available for us all to see in Roehampton Library during the period of public consultation on the application.

Do go and have a look at the application - and be sure to get your views on it sent in to the town hall before the end of the consultation period.

It will be no use complaining once

planning permission has been granted by the council - as we all know (if we think about it) it will be!

2019/2516: What's That, Then?

Well, "2019/2516" is the code number of Redrow's planning application which represents the summing of all the years-long procedure known as the 'consultations on the regeneration'. By the time you're reading this, there will have been 9 hours'-worth of final consultation on the matters.

How much of this goes over people's heads is a good question. At the time of writing (4th July), the uploaded documents in support of the application numbered 164, with 211 drawings. Paper copies are available to view at the (Roehampton) Library. Online location:

The planning application number is 2019/2516, and is obtainable by searching at <https://www.wandsworth.gov.uk/planning-and-building-control/search-planning-applications/>

Comments on the application are due by 22nd July, so that is a mighty amount of work to be done by anyone wishing to give an informed view on the proposals.

Local Councillor Is Deputy Mayor !



Councillor Sue McKinney, new Deputy Mayor, with new Mayor of Wandsworth, Cllr Jane Cooper (right)

The new deputy mayor is Cllr Sue McKinney, who represents the people of Roehampton and Putney Heath. She will be supported by her children Alex and Ruth following the recent passing away of her husband, popular Roehampton vicar Jim McKinney.

Congratulations, Sue !

Wandsworth Community Transport

FREE DAY OUT FOR THE ELDERLY AND DISABLED OF WANDSWORTH

With funding as one of the Mayor's Charities for 2018/19, we are offering a free trip to elderly and disabled Wandsworth residents this summer. Call us to register (unless you already go on our trips) and we will send you the list including all the old favourites to the coast and more!

020-8675 3812
w.c.t@btconnect.com

funded by Wandsworth Council

Summer Fun In Richmond Park!

FREE 'Pop up' activities for young children and their families.

8th August 2019

In the Roehampton Gate Garden in Richmond Park

Drop in between 11am - 2pm

STORYTELLING - CRAFTS - SENSORY FUN

Children must be accompanied by an adult at all times.

The Holly Lodge Centre: www.thehollylodgecentre.org.uk, Registered Charity No. 1076741.
The Royal Parks is a registered charity, number 1172042.

Roehampton Gate Gardens in Richmond Park.

On the left as you come in through Roehampton Gate.

Car Park, toilets & cafe available less than 5 min walk away.

Roehampton Regeneration and the community

Cllr Jeremy Ambache

1. Introduction

Your Labour Councillors have been talking to local people about the Roehampton regeneration to get your views and hopes to ensure the Council plans include them. Your Councillors consider that the current plans do not deliver enough community benefits for the £108million being invested from the Council; and we demand more than the extra 30 Council houses and better youth services, community access to spaces and improved public transport. This article explains the benefits that we are seeking and how you can help our campaign!

2. What are the needs of our Roehampton community?

The chance for community regeneration comes round once in a generation in a local area like Roehampton and our community has significant needs which badly need to be addressed. We think that these needs should be addressed by the regeneration plans by the Council and Redrow, working in partnership with others such the NHS and the local community.

o Housing

The Council's own recent report in 2018 shows that 30% of families on the Alton estate are living in overcrowded conditions. Also, many thousands remain on the housing waiting list. Poor housing adversely affects health as well as the educational attainment of children.

o Health

The health data for Roehampton show that there are high rates of illnesses such as high blood pressure, heart disease, stroke, mental illness and drug misuse. Male life expectancy is 76 and for women its 79 years. Men live 3 years less than the Wandsworth average and women 1 year less. Working with Doctors and the NHS we should all do our best to improve the health of our local community.

o Education

More than half of Roehampton pupils were eligible for free school meals over the last 6 years. Local schools have higher persistent absence rates than the Wandsworth average. Two primary schools, the Alton and Heathmere, have lower proportions of children reaching expected levels of achievement than across Wandsworth. Improving education and training is essential for the future of the younger generation.

o Employment and Income

On the Alton estate the numbers of unemployed people are higher than the Wandsworth average. And nearly half of all households (47%) are claiming housing benefit. It is important for the Council's Work Match and Citizen's Advice Bureau to engage with local people to help access employment and benefits.

We believe that the regeneration can and should act to strengthen the whole community - and it should provide better genuinely affordable housing, better health, increased employment and stronger educational performance!

3. Citizens Advice Bureau (CAB) project

My councillor colleagues and I have been pressing for some 'community development' with the aim of strengthening local resident's initiatives. We have argued that this should in parallel with the construction development over the next 8 years (the life-time of the redevelopment). The Council's Public Health Department have come up with funding for 3 years for a community development worker and CAB have been chosen to take this forward. (You may know that CAB recently moved from 166 Roehampton Lane and they are now based at Picasso Building, Mount Clare, and Minstead Gardens). The community worker will be recruited shortly and be working in the area for 3 years aiming to 'nurture area based projects which enhance local capacity and strengthen the Roehampton community'. The project will be guided by a steering group composed of local representatives.



This is good news! And we will be doing our very best to get longer term funding! We will continue to press for affordable space to be available in the new Library so that local community groups can hold meetings.

4. Labour public meeting and local survey.

To get in-depth views on the regeneration plans from local people Fleur Anderson, Labour's prospective parliamentary candidate, and your Councillors held a public meeting in March; and we have just surveyed 135 people 85 live within the area identified for development and 50 live nearby. We found:

- The overwhelming view is that the current plans do not deliver the extra badly needed Council Housing. 93% of people were in favour of more Council Housing and 7% were against.

- There were strong views that local community facilities need to be improved like youth services, leisure provision and shops. 73 residents wanted more community facilities compared to 7 who were satisfied with the current plan.

Frequent comments from residents echoed these themes:

- 'Many local people can't afford to buy - we need more Council Houses'
- 'We need banks, cash machines and more choice of shops'
- 'Buses are often late and are too overcrowded'

With these comments in mind we are campaigning to get a better regeneration deal for all local people. This is reasonable as the development is on public land and the Council is spending £108m; so it should ensure sufficient benefits for the whole community.

5. Our petition

Fleur Anderson and your Labour Councillors are collecting signatures for a petition to the Council to deliver a better deal from the regeneration. We are asking the Council to:

1. Build more Council houses (the current plans have just 30 extra Council houses). We think there should be at least 100 extra Council Houses.



2. We want more and better youth services.

3. Within the new library building provide a dedicated space for community groups to use.

4. Improve transport connections including more buses.

If you support this please sign on line at:

<http://bit.ly/AltonRegeneration>

6. What next?

Before the plans come to the Council's Planning Applications Committee there will be a period of statutory community consultation. This is likely to be before July - so do make your views known!

And if you support our petition - please do sign it!

The views of the community do really make a difference to the regeneration plans and can ensure that there are benefits for the whole community - so please keep in contact!

Cllr Jeremy Ambache

Cllr.J.Ambache@wandsworth.gov.uk

Bike Fire Risk

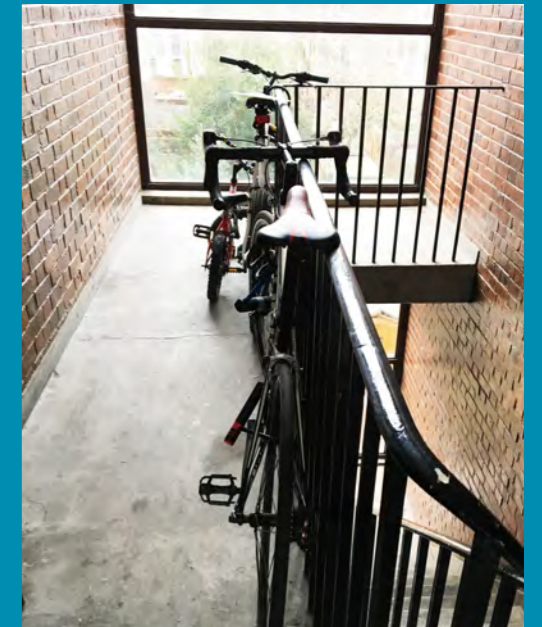

Steve Fannon

At the recent Let's Talk event one topic briefly mentioned was that bicycles have been blocking communal areas and poses a fire risk in blocking fire exits.

This is not new to the Hersham Close Residents' Association (HCRA) which has been trying to mitigate this for some time as the block letter highlights.

We've tried to do our bit by promoting increasing the amount of bicycle stands in the Ibsley neighbourhood area.

At the last count the RA has had 12 such stands across five areas, with the most recent being opposite 2-52 Ibsley Gardens.

This has been achieved through the use of the Council's Small Improvement Budget, which is something that the RA is thankful to the Resident Participation Officer and Estate Manager is greatly assisting with.

Hersham Close Residents' Association

hersham.close@yahoo.co.uk

72: How are the buses doing now?



You need to go to Cornwall now if you want to catch a number 72 bus!

Alex Gautier

On Saturday 18th May, Roehampton lost the 72 bus service. TfL say they will double up the 265 bus to compensate. Will this be enough? Time will tell. I am writing this article on 16th May, wondering what on earth is going to happen. Is this the calm before the storm?

If you take the 72 bus to Barnes Station or Hammersmith and beyond and are unhappy with the change in service, please register your complaint at yoursay@tfl.gov.uk. It doesn't take long and it's really important that we pull together and let TfL know what they are doing to our lives. The more complaints they receive, the more they will listen, though I really hope

everything will be fine for those who need to travel on the buses.

TfL's remedy of doubling up the 265 bus is not working - the average speed of the 265 bus due to traffic congestion is just under 4 miles per hour!

CLlr Steffi Sutters, our local [West Putney] Conservative councillor, has set up a petition for us to vote online with the request that our Council Officers press our case. I know this is Conservative branded, but whatever your political standing is, or none, this is the best way forward at the moment to try to get the 72 bus restored south of the river.

I would be grateful if you would complete the petition at:

<https://www.wandsworthconservatives.co.uk/bringbackno72bus>

I was surprised to be asked my political preferences on page 2. If you don't want to answer those questions, don't. Just press submit.

So, please let's get this petition going, and get the 72 bus back to Roehampton!

TfL bus transportation for the Roehampton Lane area was never brilliant, but with the closure of Hammersmith Bridge, it's so much worse and is likely to be for the next three years from what we understand. There have been apologies and best intentions expressed by our elected officials, but money is in scarce supply so it is extremely important that we complain, complain, complain.

Please send relentless emails to Customerservice@tfl.gov.uk. The squeaky wheel gets the oil and in this case I have heard TfL officials comment that people find different ways to get where they are going - in other words, 'no big deal'. So please let TfL know that it is a big deal.

Buses are our only option here and they need to IMPROVE!

'LETS TALK' Event - Some thoughts

Steve Fannon

Hopefully you were one of the lucky ones that attended the Let's Talk event on 15th May at the Holy Trinity Church. What an event it was, though two things first:

These events happen every two years, near enough, and the last one was held in September 2016. Some residents have suggested that the delay in bringing this to Roehampton was in the hope that the regeneration planning would have come and gone, and that the water sprinkler situation would have been out of the way. I'll leave that with you to decide whether there's something in that.

It really is a concern that there is no community space for such events. How did it get to this stage? So sad... On the night the acoustics were poor and residents struggled to listen to what was being said (or

not said). Answering questions by Councillor Govindia was skilfully dodged. How many questions were raised on the night that were not answered.....such as when the next Let's Talk event will be given the wait for this one and whether he'll attend a meeting on the Alton Estate to discuss water sprinklers with those concerned.

It was worrying that on some topics residents seemed to be at vastly different levels of understanding. One resident from the Lennox Estate asked whether he could obtain a copy of a Risk Assessment for his building. Surely everyone should know how they can access this by now, though it's not the case because the Council does not communicate to residents how they can access these reports.

Councillor Ambache referred to the September 2016 Minutes as did a resident later on regarding

Roehampton University's portcabins and that it would be good to have an update on that (there was no given). It was appreciated the Labour MP candidate Councillor Fleur Anderson was at the top table though to counter this then MP Justine Greening should have been there too?

There were a lot of unhappy residents making their points known though this felt very much like a box ticking exercise whereby the Council will highlight it has engaged with residents. It will be very interesting what the Minutes will state and it is likely that any actions from them will be fleetingly followed up before falling into a black hole (e.g. portcabins). These events should be renamed 'Let's Talk and not expect any answers'.

Steve Fannon,

roeregeneration@yahoo.com

'Now And Then' University of Roehampton

No. 10: Grove House

José Malheiro Magalhães – PhD student, University of Roehampton

Gilly King – History and Heritage Advisor, University of Roehampton

Circa 1843, Charles Lyne Stephens, purportedly England's richest commoner, acquired the Roehampton Grove estate for an estimated £24,000.

The estate was composed of two villas, Roehampton Grove House and Lower Grove House, and 144 acres of land. Roehampton Grove house was built on the foundations of a larger 17th Century villa, known as 'Roehampton Great House', built by David Papillon in the early 1620s. No picture of this house survives.



Roehampton Grove (Grove House), John Hassell - 1804

In about 1790, the house was pulled down by the new owner, Joshua Vanneck – a very successful Dutch merchant and the 1st Baronet of Putney – who commissioned James Wyatt to build a smaller, neoclassical villa, which became known as Roehampton Grove. This was the house that Charles acquired and where he lived for the rest of his life. After their marriage in 1845, Charles' son, Stephens, and his infamous wife Yolande Duvernay moved into the estate, occupying Lower Grove House which was situated in what today is the Fairacres residential apartments.

This lower house was joined to the main grounds through a path that still exists today.

After the death of his father in May 1851, Stephens moved with his wife into Roehampton Grove where he would eventually die in 1860.



Fifteen aviators of the United States Naval Reserve Flying Corps outside Lower Grove House - 1917 (The officer in the centre is an Englishman)



Lower Grove House, c1930. Demolished in 1935



Grove House - 2018

ROEHAMPTON PARISH TRUST

REGISTERED CHARITY

Making Grants in Roehampton

Roehampton Parish Trust is a small local grant making trust that can provide grants of up to £5000 a year to support local groups and charities working in Roehampton.

For further information please email
Carol@cecampbell.me.uk

Roehampton Parish Trust holds an endowment fund that was formed in 2015 from the proceeds of the sale of the parish hall. The income from this trust is used by the trustees to give grants to local groups to help them put on events, provide services, support building repairs in Roehampton.

In the three years that the trust has been supporting local groups we have helped a number of local groups as well as both Holy Trinity Roehampton and Minstead Gardens Methodist church.

Our first round of grantmaking was varied and interesting, we provided football kit for a local club, gave a capital grant to regenerate Rise, and helped with the Christmas lunch at the Kairos Centre.

Some of our stories:

Parkinson's People - This group runs Roehampton's only chair based exercise group, and the trust agreed to be their core supporter for three years to help sustain the group and give them time to develop without worrying about core funding.

Sixty+ Cafe - We have given the cafe funds each year to help provide transport, run dance classes, and support events

Holy Trinity Roehampton - We have provided funds for a part time staff member to help keep the church open during the week.

And finally we have a grant to support this magazine for 5 issues.

If you think a grant from us could support a group, an event, or a local initiative please email: carol@cecampbell.me.uk

Making cyclists happy

Alex Gautier

Three cheers for Wandsworth Council - or TfL - whoever it was that introduced two-way cycling on Roehampton High Street. At long last we can cycle along Putney Heath and continue down Roehampton High Street to get home after a hard day's work. Thank you, thank you, thank you.

Ubuntu Museum comes to Roehampton!



Ubuntu Museum is a social enterprise with a mission to promote cultural inclusivity within education and the arts.

Its founder, Jackie Mwanza, says, "We are in the process of developing new workshops and a Pop-Up gallery based on stories with characters that originate from Africa. I was born in Zambia and the word Ubuntu in my language means humanity."

"When I first registered the company a year ago I wanted it to be referred to as an African Museum, now I believe it's more fitting that we are known as a museum of humanity."

Of course the central characters in the stories we will be exploring and sharing will be of African descent, but ultimately we want to show how they are intrinsically connected to the world. Ubuntu Museum is not a traditional museum in the sense that we haven't got any old artifacts to display. We will have a Pop-Up gallery; our very first one will be The Nude Gallery.



The Nude Gallery is a collection of items that are deliberately made to mimic skin tones i.e. plasters, make up foundation, prosthetics, ballet shoes etc...



Meet Mbiya! Ubuntu Museum's heroine

flesh/nude coloured tights to match her dark skin tone. This gallery is an exploration of the relationship between products in the colour 'nude' and the commercial world's values regarding race and diversity. We are also interested in finding out what our audiences feel about this topic."

Jackie Mwanza is a local artist. She lives on Alton Estate. She established Ubuntu Museum after a 12 year career as a Museum workshop facilitator at the Victoria and Albert Museum in London.

Ubuntu Museum will be setting up residency with Roehampton ROCKS at The Alton Activity Centre on Ellisfield Drive. They will be offering workshops for school groups and family days soon.



Jackie Mwanza founder of Ubuntu Museum

www.ubuntu-museum.com
Instagram @ubuntu-museum

Holybourne Day Centre

As it may be known, the Four Seasons Health Care Group is changing hands, following a spell in the hands of a private equity owner and entry into administration.

However, this is not expected to disrupt the day-to-day operations of the Day Centre, nor of any other of the care homes which are Four Seasons' business. The company's Chief Executive Officer said at the end of April:

"[N]o changes to our care services; no difference in our homes or offices; there will be no change to our management teams, no changes to jobs or employment; no changes to our relationships with suppliers of product or services. No unscheduled closures are expected as a result of the sales process being launched."

This optimism is shared by Christine Smith, who readers may remember from our article featuring the Day Centre a couple of years ago.

Keep on doing what you're doing, people!

Men's Shed



After a year of hard graft refurbishing an old garage Roehampton Men's Shed is now operating as a community workshop. We have a group of local people who have the will, and sometimes the skill, to take on a variety of jobs, making and repairing stuff for the community in Roehampton and Putney.

This ranges from putting up shelving, making garden planters, bird boxes and even dog kennels.

At present we are open Wednesday afternoons and our workshop is in Clare Place, Minstead Gardens, round the back of the Methodist Church.

If you have a job you'd like us to do, want to join us, or just want a chat and a cup of tea, please drop in, or get in touch.

Dave Peers,

Roehampton Men's Shed Co-ordinator,
07950 931626

davidw.peers@gmail.com

Roehampton Visual contest

A very kind offer has been made, and we are pleased to advertise it through the pages of the Roehampton Voice.

It is open to young people under the age of 16 living in Roehampton, and is in two categories, photography and painting or drawing.

The prize for each category is £50.

The image must capture an image of Roehampton, such as its buildings or its landscape.

All work must be original, and should be submitted as digital photographs to roehamptonvoice@hotmail.com

Not more than one prize will be awarded to any one person, no matter how good their entries!

The deadline for all submissions is Saturday 31st August (midnight).

Good luck, entrants!

Holybourne Day Centre

Relaxing, chatting and enjoying good company in a welcoming atmosphere



FREE trial day

Experienced day care providers

Specialists in dementia care

Great daily programme of social activities

Home cooked hot meals, snacks and refreshments

Open 7 days a week – 8am to 6pm
(9am-5.30pm Sunday)

Pick up and drop off service available on request

For more information, including prices, please get in touch.

T: 020 8003 0272

www.fshc.co.uk/holybourne

Holybourne Day Centre, Holybourne Avenue,
Roehampton, London SW15 4JD

Roehampton mounting block comes home

Phil Evison

In 1654, with Oliver Cromwell our Lord Protector and a recent regicide etched in peoples' memories, Thomas Nuthall of Roehampton was appointed local surveyor of roads and had a mounting block/milestone set up on Roehampton Vale, probably to mark his appointment. It stood there, for the benefit of horse-riders, for some 200 years, before being moved and lost. Found by chance in 1921, during the demolition of an old tithe barn in Parish Yard, off Wandsworth High Street, it spent the next 60 years displayed in nurseries (later a garage) on West Hill. Having been moved a further five times over the following three decades to various places, including Wandsworth Museum and, latterly, the University of Roehampton, a campaign to find a home for it began in 2013, involving the council and other local representatives. This culminated in its official unveiling,



on Friday 26th April 2019, at its new, permanent site – at or near its original one – outside the East Lodge gates of Putney Vale Cemetery. Funding for the re-installation and restoration of the mounting block, an information board, and restoration of the gates

and the nearby 9-mile milestone, came from the Wandsworth Local Fund (a charge levied by the council on local developers) and the unveiling ceremony was performed by the council's arts and heritage spokesperson, Cllr. Steffi Sutters.

Roehampton Voice: Summer 2019 Edition

Credits for this issue

We record here our great thanks to Sawiya Ali, who stepped in at very short notice to design this issue.

Events

Please pass us details of your events, for inclusion on our outer back page.

Advertising

Advertising in the Roehampton Voice still represents exceptional value for money. For the very reasonable rates below, you can

reach every one of our circulation of 6,150 households throughout Roehampton.

Rates:

£20 for 1/8th page

£50 for 1/4 page

£100 for 1/2 page

£200 for a full page

If you've an event happening between issues: we will be only too glad to publicise your event on Facebook and Twitter.

Contact us at:

The Editor, Roehampton Voice
Roehampton Trust
80 Coombe Road
New Malden

Surrey KT3 4QS

roehamptonvoice@hotmail.com

(020) 8785 4690

[@RoehamptonVoice](https://twitter.com/RoehamptonVoice)

[Roehampton Voice](https://www.facebook.com/RoehamptonVoice)

www.roehamptonvoice.online

The Roehampton Voice is published as a project of the Roehampton Trust

The deadline for contributions for the next issue is Monday
12th August 2019 – articles and advertisements both.

Publication date early September 2019

Weekly events

Knit & Sew

Alternate Wednesdays // 2:00 – 4:00 pm

All ages, skills and levels!

Friendly, fun, informal

Roehampton Library, Danebury Avenue

Kickboxing

Every Tuesday // 6:30 – 8:00 pm

Contact Mark Smith 07732 837 777

First session free

Newlands Hall, 226 Stroud Crescent,

Putney Vale, SW15

Stay and Play session

Wednesdays // 10 – 11.30 am

for children 0-5 years and their adults

Free, health worker also present

Run by Eastwood Centre

020 8871 5544

Health worker: 0330 058 1679

Newlands Hall, 226 Stroud Crescent

Chair-based Exercises for People with a Disability

Tuesdays // 2 classes // 12.30 and 2:30

£3 per class; refreshments provided

Andy Butler – 07769 224793

Chestnut House, 209 Arabella Drive,

SW15 5LH

Ballroom/Latin American/Line Dancing

Every Wednesday // 2:00 – 3:30

Enquiries: (020) 8876 6794

Lennox Clubroom

42 - 59 Ludovick Walk, SW15 5LE

Roehampton Activity Centre

Every Wednesday // 11:00 – 2:30

Warm and cosy – have lots of fun socialising and mixing with others, plus outings

Vicarage Court, Alton Road (next to The Cornerstone)

Farmers' Market

Every Thursday // 1:00 – 2:00 lunchtime

Selling organically grown vegetables, bread, fresh eggs and more

The Hive Café, Digby Square (at the University)

Baby Rhyme Time

Every Wednesday // 10:30pm

Story Time

Every Friday // 10:30pm

both at Roehampton Library, Danebury Ave

Zumba Session

Every Monday evening // 8:00 – 9:00

First session free

020-8871-6373 or www.enablelc.org

Newlands Hall, 226 Stroud Crescent

60 Plus Café

Every Thursday // 11:00 – 2:00

Good food and company for all older Roehampton residents and carers

Methodist Church, Minstead Gardens

Footcare Service

Every Thursday at the 60 Plus Café //

10:30 - 2:30 pm

£10.00 per session

Book on (020) 8788 5577

Methodist Church, Minstead Gardens

Dance Classes for Women

Every Wednesday // 10:00 – 11:00

Urban dance to popular, empowering music

Babies' safe play area

£3 a session // Contact Kiri 07508036180

Eastwood Children's Centre, 166 Roehampton Lane, SW15 4HR

Bingo

Every Friday // 6:30 start: 7:30 eyes down, finish about 9:00

Cash prizes, raffle, refreshments – entry 50p, books £1.20 each

Alton Community Hall, 1 Petersfield Rise

Crafts and Knit & Natter

Wednesdays // 1:30pm – 4:00pm (music exercises at 1.15-1.30)

Bring your own needles and wool – info Rachel McCarthy 07904 152729

Minstead Gardens Seniors' Clubroom

Yoga class

Thursdays // 9.30 - 10.30am

First session free

020 3959 0033

Newlands Hall, 226 Stroud Crescent, Putney Vale, SW15

Roehampton Library, Danebury Avenue

Coding and STEM

A new activity in partnership with students from Istock Place School.

Every Friday // 3:30 - 4.15 pm

English conversation classes

Every Monday // 5:30 - 6.30 pm

both at Roehampton Library, Danebury Avenue

Ti-Chi For Health

Every Tuesday // 11:00 - noon

£2.50 per session

Methodist Church, Minstead Gardens

CEDARS Youth Club

Every term-time Tuesday // 5.30 - 7pm

For children aged 7-11

£1 per child per session

Methodist Church, Minstead Gardens

+55 Stretch & Movement Class

Thursdays // 10.30am - 11.30am

For beginners, First session free (£3)

Emma 020 8871 8712

etoft@enablelc.org

Newlands Hall, 226 Stroud Crescent, Putney Vale, SW15

Monthly events

Councillor Surgeries

Second and fourth Saturday // 11:00 – 12:00

Roehampton Library, Danebury Avenue

Walking For Health

On Putney Heath and Wimbledon Common. The first Sunday of every month. Meet at 10.30am at the Shell petrol station, Roehampton Lane. Group led by John Horrocks. Finish at about noon.

Alton Regeneration Watch

We meet every third Wednesday of the month at the DARA Club, Focus Hall, Minstead Gardens, SW15 4ER. Start at 7:30 pm for a finish round about 9:30.

The 'regeneration' connects with so many other issues - please don't miss the chance to attend and raise your voice.

Roehampton Forum

Next meeting due in July: follow social media or check our website roehamptonvoice.online for updates.

Roehampton Partnership

Thursday, 5th September at 7:00 pm, location t.b.a., probably Manresa Clubroom.

Contact Fiona Rae on (020) 8871 6010 or fiona.rae@richmondandwandsworth.gov.uk

Roehampton Festival

It WILL be on this year, on 7th September, at the usual place - Bull Green. aka Downshire Fields.